

REVISIONS				
ZONE	REV	DESCRIPTION	DATE	APPROVED
	REV B	Changed item 8 from 504074 to 504073 (10/5/05)		
	REV C	Changed all washers to precision (7/25/08)		

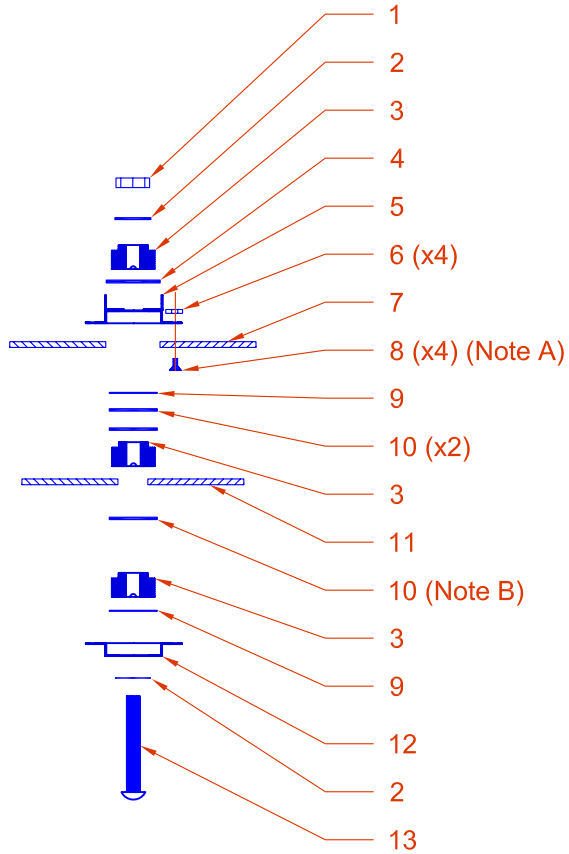

Grid Assembly Stack  
(Collimated)

Item	Description	Part No.
1	6-32 Nut	504082
2	No 6 Washer 0,015"T	504284
3	No 6 Male Insulator	504008
4	Washer 0,312" ID x 0,025"T	504632
5	Hat-Cup	504253
6	0-80 Nut	504071
7	Screen Grid	504430
8	0-80 Screw	504073
9	Washer, Precision, 0,010"T	504286
10	Washer, Precision, 0,025"T	504287
11	Accel Grid	504429
12	No 6 Hat	504024
13	6-32 SL Screw	504080

Note A: For one stack, substitute 504216 for attachment to screen strap.  
 Note B: For one stack, the Accel electrical strap is inserted.



(970) 663-6988

1714 Topaz Dr. Unit 110  
 Loveland, CO 80537

Unless otherwise stated tolerances are +/- 0.005". Do not scale drawing. Remove all burrs. All threads are CLASS 2.

This drawing is the property of Plasma Process Group, Inc. and may not be reproduced or disclosed to others without authorization by Plasma Process Group, Inc.

DRAWN: BWB CAD: BWB		SIZE	FSCM NO.	DWG NO.	REV
				504431 - 15 cm G ASM	C
SCALE 1:2		Date: 6/16/05		SHEET 1 of 1	