

| REVISIONS | | | | |
|-----------|-----|-------------|------|----------|
| ZONE | REV | DESCRIPTION | DATE | APPROVED |

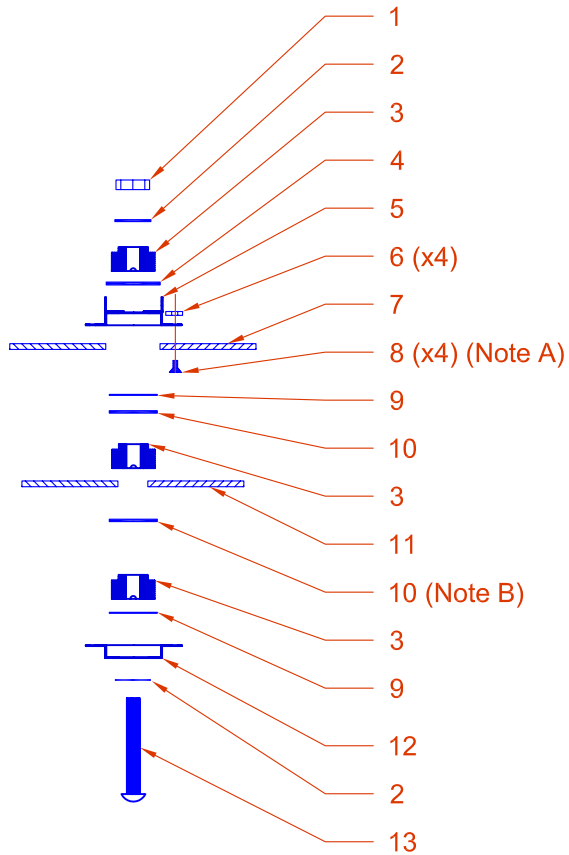

Grid Assembly Stack
(Collimated)

| Item | Description | Part No. |
|------|---------------------------------------|----------|
| 1 | 6-32 Nut | 504082 |
| 2 | No 6 Washer 0,020"T | 504089 |
| 3 | No 6 Male Insulator | 504008 |
| 4 | Washer 0,312" ID x 0,550"OD x 0,025"T | 504144 |
| 5 | Hat-Cup | 504253 |
| 6 | 0-80 Nut | 504071 |
| 7 | Screen Grid | 504430 |
| 8 | 0-80 Screw | 504073 |
| 9 | Washer, Precision, 0,010"T | 504286 |
| 10 | Washer, Precision, 0,025"T | 504287 |
| 11 | Accel Grid | 504429 |
| 12 | No 6 Hat | 504024 |
| 13 | 6-32 SL Screw | 504080 |

Note A: For one stack, substitute 504216 for attachment to screen strap.
 Note B: For one stack, the Accel electrical strap is inserted.



(970) 663-6988

1714 Topaz Dr. Unit 110
 Loveland, CO 80537

Unless otherwise stated tolerances are +/- 0.005". Do not scale drawing. Remove all burrs. All threads are CLASS 2.

This drawing is the property of Plasma Process Group, Inc. and may not be reproduced or disclosed to others without authorization by Plasma Process Group, Inc.

DRAWN: BWB CAD: BWB

| | | | |
|-------|----------|----------------------|--------------|
| SIZE | FSCM NO. | DWG NO. | REV |
| | | 504551 - 15 cm G ASM | A |
| SCALE | 1:2 | Date: 11/17/05 | SHEET 1 of 1 |